

S. 75-908

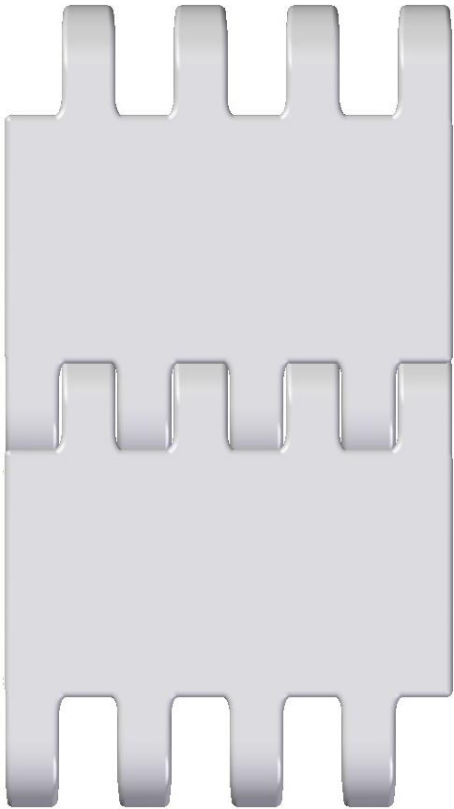

Belt data		
Materials	Max. belt pull kg/m of width	Belt weight kg/m ²
Polypropylen (PP)	10.000	22
Polyacetal (POM)	16.000	33

Belt surface: Closed flat top.
Open area: Closed.
Strength: The right belt for very heavy applications.
Material/colour: PP, POM/black & Yellow.
Cleanability: Good.
Accessories: 50 mm finger flight. Side Guards 40mm.
Application: Very heavy transportation.
 Assembling belt for cars.
 Truck loading systems.
Standard widths: Increments of 25 mm, e.g. 100, 125 mm etc

Registered Trademark ®

Sprocket Data								
No. of teeth	A= Outside diameter	B= Pitch-diameter	C= Inside-diameter	Hub width:	Round bore		Square bore	
					mm	in.	mm	in.
upon request	310	280	250	40	mm		mm	
12					40/60		60/80/90	

