

S. 50-908

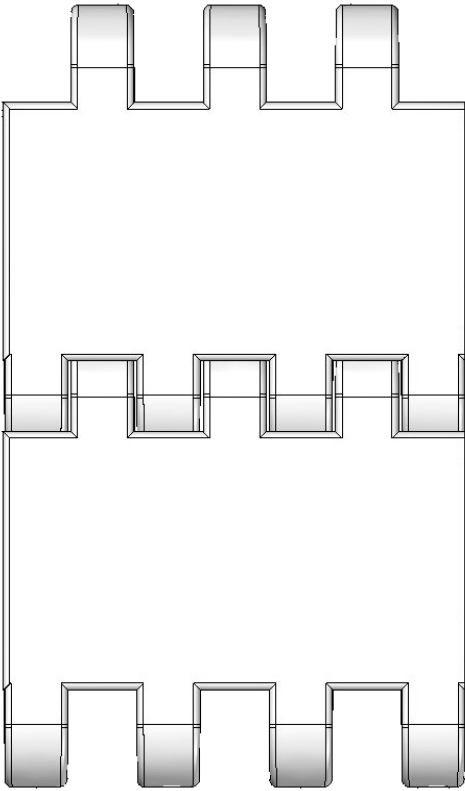

Belt data		
Materials	Max. belt pull kg/m of width	Belt weight kg/m ²
Polyethylene (PE)	4800	13
Polypropylene (PP)	6000	14
Polyacetal (POM)	10250	21

Belt surface: Closed flat top.
Open area: Closed.
Strength: The right belt for very heavy applications.
Material/colour: PP, POM/black.
Cleanability: Good.
Accessories: 25 mm flight, 50, 60 mm comb flight
Application: Very heavy transportation.
 Assembling belt for cars.
 Truck loading systems.
Standard widths: Increments of 20 mm, e.g. 100, 120 mm etc

Sprocket Data								
No. of teeth	A= Outside diameter	B= Pitch-diameter	C= Inside-diameter	Hub width:	Round bore		Square bore	
					mm	in.	mm	in.
12	210	191	172	40	40/60		60/80/90	
16	273	254	235	40	40/60		60/80/90	
18	307	288	269	40	40/60		60/80/90	

