

S. 50-608

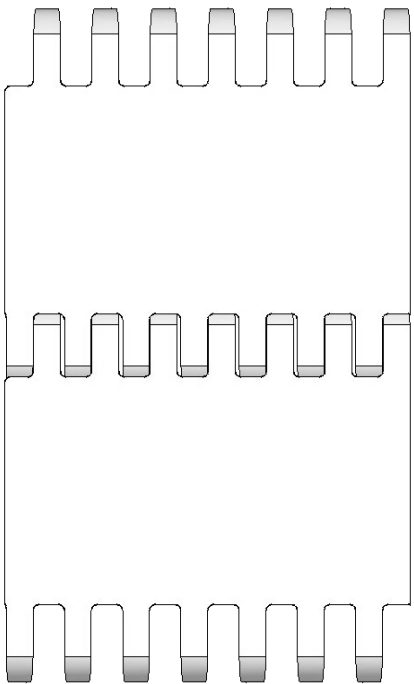

Belt data		
Materials	Max. belt pull kg/m of width	Belt weight kg/m ²
Polyethylene (PE)	1790	7
Polypropylene (PP)	2400	7
Polyacetal (POM)	3600	11

Belt surface: Flat top.
Open area: Closed.
Strength: The right belt for medium-heavy transportation.
Material/colour: PE/nat and blue, PP/white and grey. POM/blue.
Cleanability: Excellent. FSIS.
Accessories: 25, 50, 75 and 100 mm flights. Scoop and bent flights. 75 and 150 mm supported flights. 50, 75, 100 and 150 mm side guards. 50 mm comb flights. Friction top. Flights fitted with a round top.
Application: Dairy, vegetables, poultry, snacks, sweet goods and other industries that handle small products.
Standard widths: Increments of 10 mm, e.g. 100, 110 mm etc

Sprocket Data								
No. of teeth	A= Outside diameter	B= Pitch-diameter	C= Inside-diameter	Hub width:	Round bore		Square bore	
					mm	in.	mm	in.
6	103	89	73	20	20/25/30/40	¾/1/1¼	25 /40	1½
8	136	122	106	35	25/30/40	1/1¼	25/40	1½
10	170	156	140	35	25/30/40	1/1¼	25/40/60	1½/2½
12	203	189	173	35	25/30/40/50/60	1/1¼	25/40/60	1½/2½
16	268	254	238	35	25/30/40/50/60	1/1¼	25/40/60	1½/2½

