

## S. 25-801

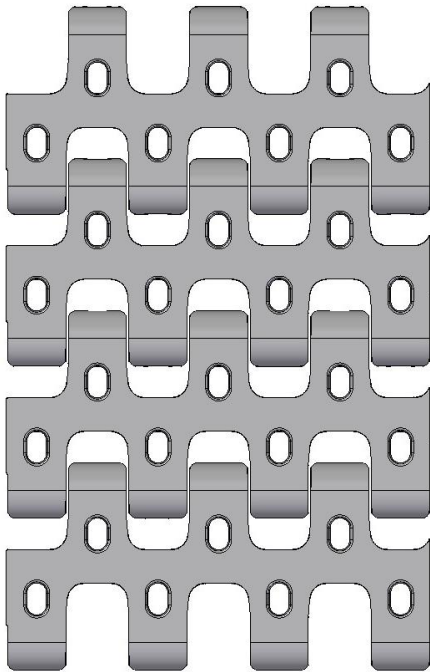

Belt data		
Materials	Max. belt pull kg/m of width	Belt weight kg/m <sup>2</sup>
Polyethylene (PE)	550	5
Polypropylene (PP)	650	5
Polyacetal (POM)	1050	7,5

**Belt surface:** Open belt with smooth surface.  
**Open area:** 41%. Biggest opening 10 x 5 mm.  
**Strength:** An ideal choice for light transportation.  
**Material/colour:** PE/nat, PP/white and grey. POM/blue.  
**Cleanability:** Excellent. FSIS.  
**Accessories:** 3, 25 and 50 mm flights. 25 and 50 mm side guards, friction top. 50 and 75 mm scoop flights.  
**Application:** Red meat, vegetables, seafood, fruit, snacks and pastry.  
**Standard widths:** Increments of 20 mm, e.g. 100, 120 mm etc.

Sprocket Data								
No. of teeth	A= Outside diameter	B= Pitch diameter	C= Inside diameter	Hub width:	Round bore		Square bore	
					mm	in.	mm	in.
6	59	50	41	20	20			
12	106	97	88	20	20/25/30/40	¾/1/1¼	40	1½
20	170	161	152	35	25/30/40	¾/1/1¼	40/60	1½/2½

