

S. 25-800

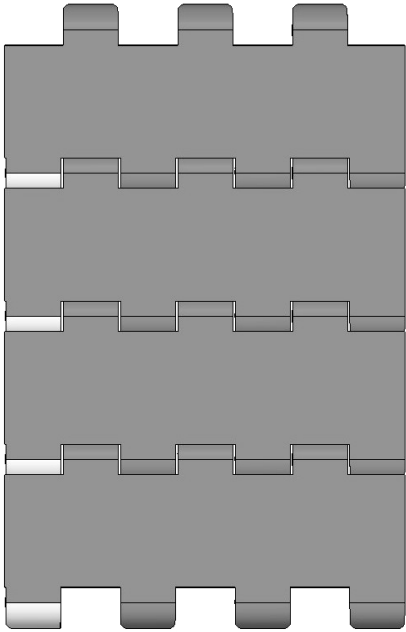

Belt data		
Materials	Max. belt pull kg/m of width	Belt weight kg/m ²
Polyethylene (PE)	550	5
Polypropylene (PP)	650	5
Polyacetal (POM)	1050	7,5

Belt surface: Flat top.
Open area: Closed.
Strength: An ideal choice for light transportation.
Material/colour: PE/nat and blue, PP/white and grey. POM/blue.
Cleanability: Excellent. FSIS.
Accessories: 3, 25 and 50 mm flights. 25 and 50 mm side guards, friction top. 50 and 75 mm scoop flights
Application: Red meat, vegetables, seafood, fruit, snacks and pastry.

Standard widths: Increments of 20 mm, e.g. 100, 120 mm etc

Protected by the EU Design Registration

Sprocket Data								
No. of teeth	A= Outside diameter	B= Pitch diameter	C= Inside diameter	Hub width:	Round bore		Square bore	
					mm	in.	mm	in.
6	59	50	41	20	20			
12	106	97	88	20	20/25/30/40	¾/1/1¼	40	1½
20	170	161	152	35	25/30/40	¾/1/1¼	40/60	1½/2½

