

S. 25-400

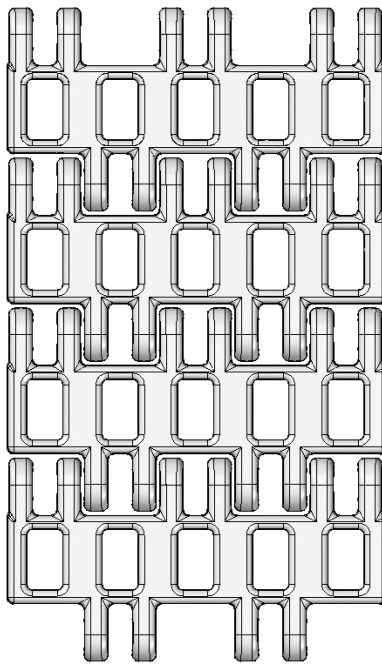

| Belt data | | |
|--------------------|---------------------------------|----------------------------------|
| Materials | Max. belt pull kg/m of width | Belt weight kg/m ² |
| Polyethylene (PE) | 630 | 5 |
| Polypropylene (PP) | 1060 | 5 |
| Polyacetal (POM) | 1500 | 7 |

Belt surface: Open belt with a smooth surface.
Open area: 29 %. Biggest opening 6 x 10 mm.
Strength: Ideal for medium weight transportation..
Material/colour: PE/nat and blue, PP/white and grey. POM/blue
Cleanability: Excellent. FSIS
Accessories: 3, 25 and 50 mm flights. 25 and 50 mm side guards, friction top.
Application: Seafood, red meat, vegetables, bakery and food industry in general. Even cooling/freezing and washing.

Standard widths: Increments of 25 mm, e.g. 100, 125 mm etc

Non standard widths: Increments of 12,5 mm, e.g. 100, 112,5 mm etc

Note: Non standard widths will have cut edge on one side.

Protected by the EU Design Registration

| Sprocket Data | | | | | | | | |
|---------------|---------------------|-------------------|--------------------|------------|-------------|-------|-------------|-------------|
| No. of teeth | A= Outside diameter | B= Pitch diameter | C= Inside diameter | Hub width: | Round bore | | Square bore | |
| | | | | | mm | in. | mm | in. |
| 6 | 54 | 45 | 36 | 20 | 20 | | | |
| 8 | 70 | 61 | 52 | 20 | 20/25 | 1 | 25 | |
| 12 | 104 | 95 | 86 | 20 | 20/25/30/40 | 1 1/4 | 25/40 | 1 1/2 |
| 20 | 169 | 160 | 151 | 35 | 25/30/40 | 1 1/4 | 25/40/60 | 1 1/2/2 1/2 |

